

MURRAY COUNTY.

Section 7
 10785 McGill-Warner Co., Blank Book Manufacturers, St. Paul.

Township 108

Range 110

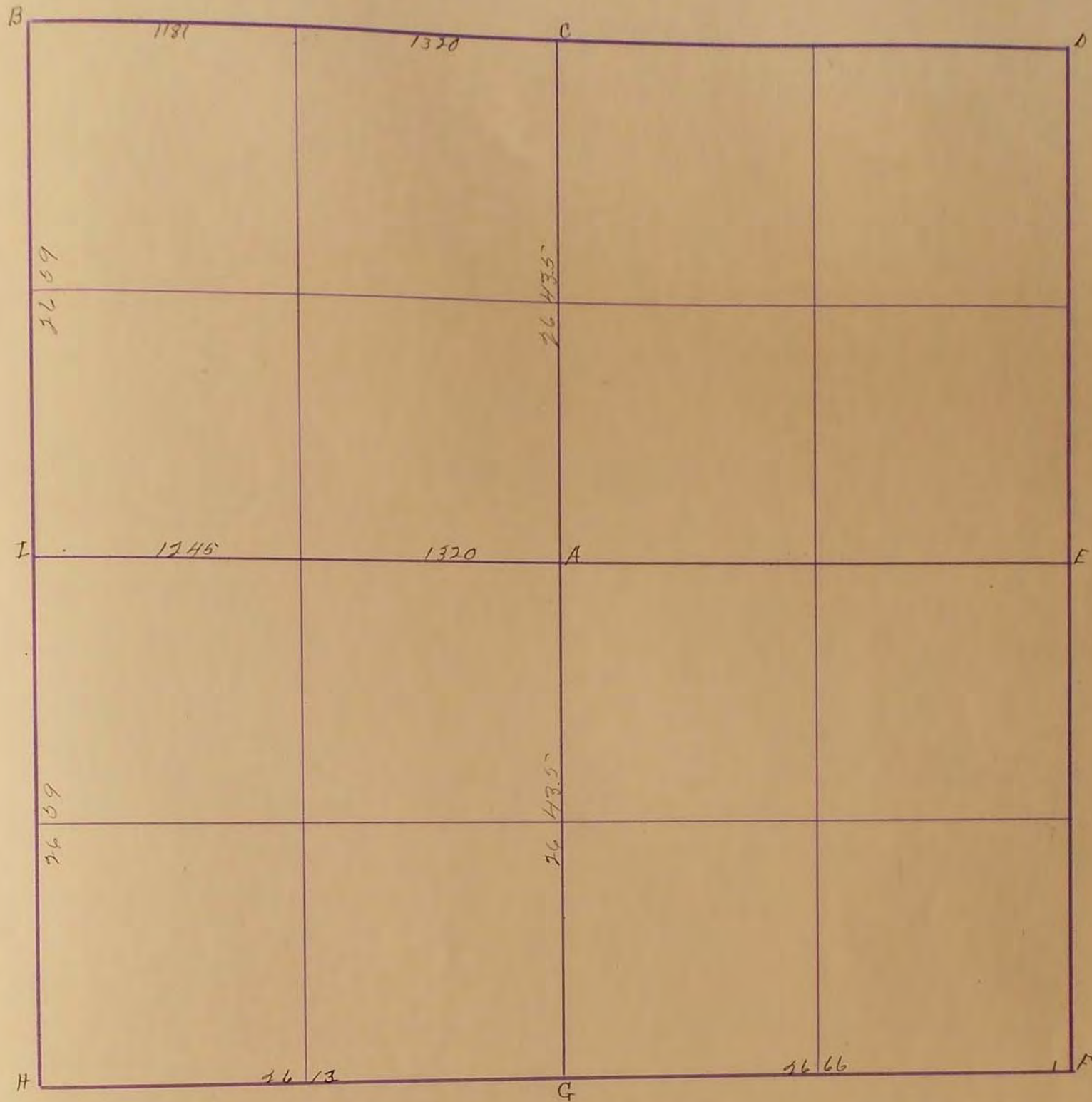

- A.
- B.
- C.
- D.
- E.
- F.
- G.
- H.
- I.

{ R.P. Tack in Tel pole NE. 44°
 F. "Stone" { R.P. Tack in Blazed fence cor SE 42°
 { R.P. Tack in Blazed fence post SW 44.2'; R.P. Tack in cor fence post south
 G. "Stone" { R.P. Tack in cor fence post North on Line 33° on Line 41'

J. H. Hoolstencroft

Apr 19-1901

D. Stone 10x13x20 grey with cross

J. H. Hoolstencroft

Apr 16-1932

Reestablished G. by measure F-H and A-G

6
7
8
9
10
11
12
13
14
15
16
17

20
21
22
23
24
25
26
27
28
29
30
31
32
33
34
35
36

SURVEY No. _____

Section 7 Town 108 Range 40

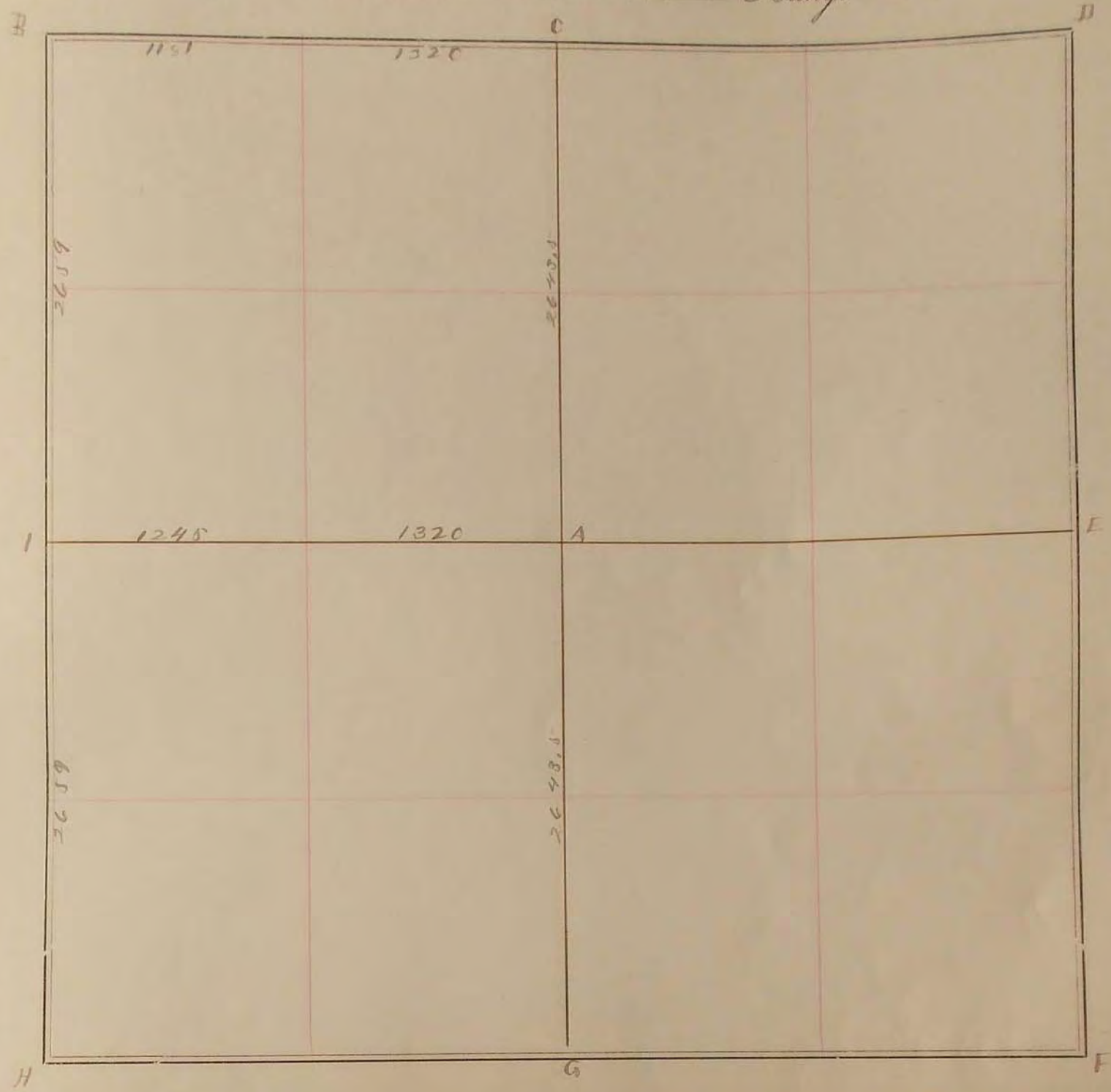

FIELD NOTES.

- A
- B
- C
- D
- E
- F
- G
- H
- I

J. W. Woodsteward

SURVEY No. _____

Section 7

Town 108

Range 40

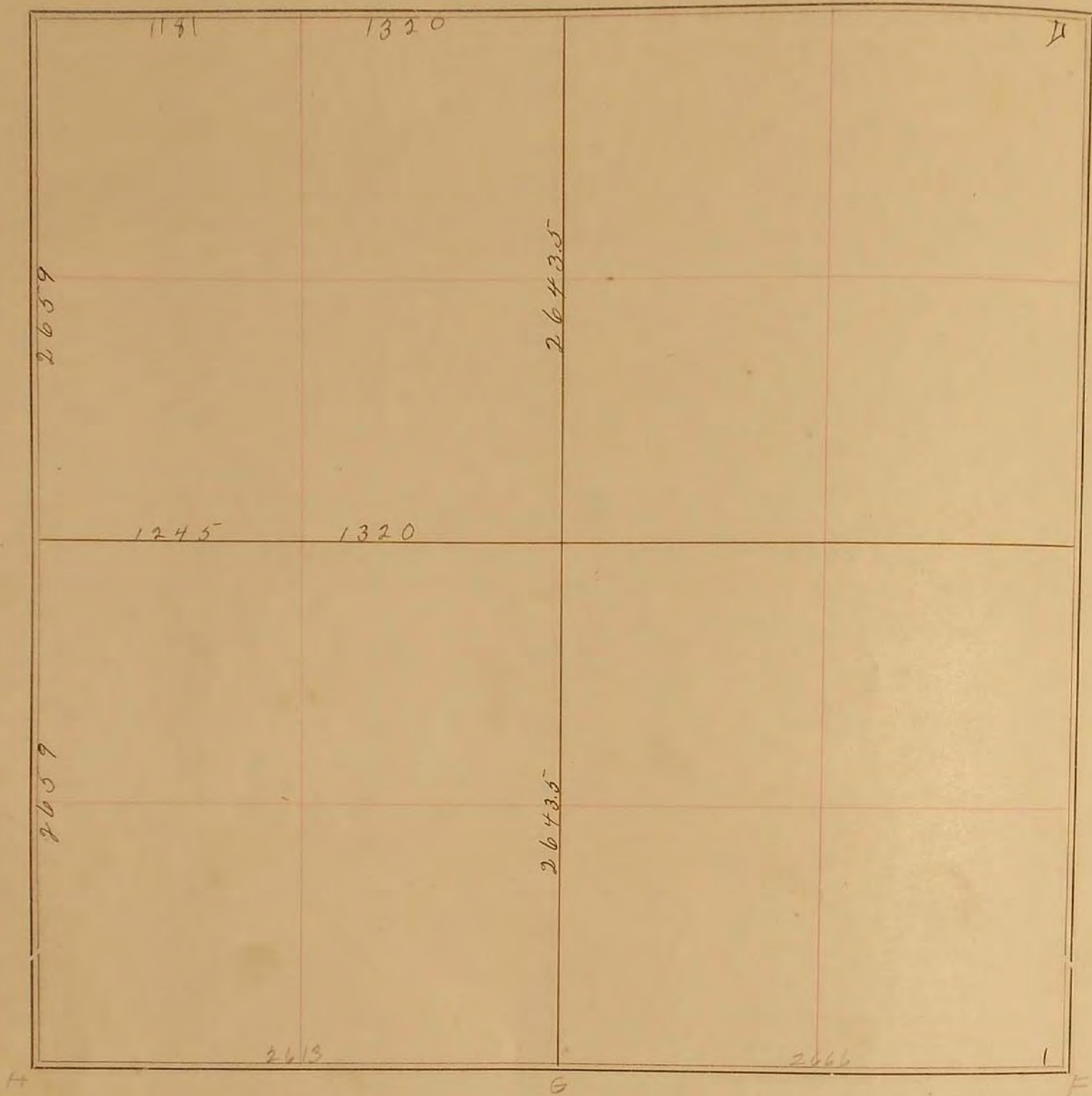

FIELD NOTES.

April 19, 1901.

⊠ stone 10 x 12 x 20 grey with cross.
J.W. Washburn

Apr. 16, 1932
Reestablished G by measure F-H, and A-G.

2587
2666
1179

SURVEY No. _____

Section 7 Town 108 Range 40

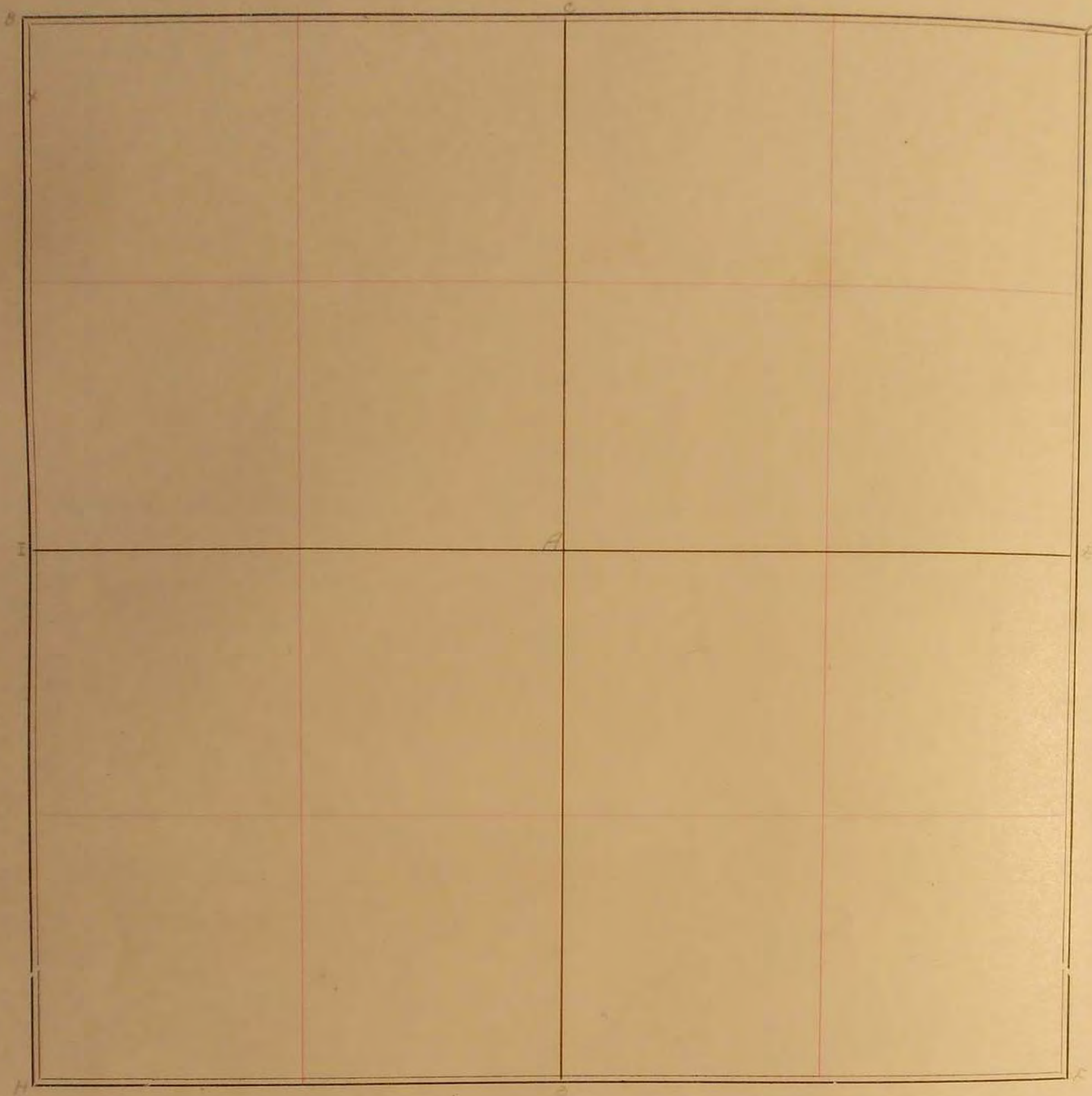

FIELD NOTES.

Martin E. Keopman Co. Surveyor, Oct. 17 - 1924. Westside C.P. 11 Temp. 60°

- A
- B
- C
- D
- E
- F
- G
- H Stone Corner at intersection Main Stone Bottom Hill with 1st St. 4 in. top 4x14 x 10" $\frac{3}{4}$ BR 2 1/2 SE, Corner Corner Post
- I Stone in center of grade 7/8 iron Bolander Party, E. face white
- J Meander Corner Stone 4x10 x 2" Iron Bolander Party K.I. Corner